

# DAWN – model: WS-W22

## LED Outdoor Sconce Luminaire

MODERN FORMS



Fixture Type:

Catalog Number:

Project: \_\_\_\_\_

Location: \_\_\_\_\_

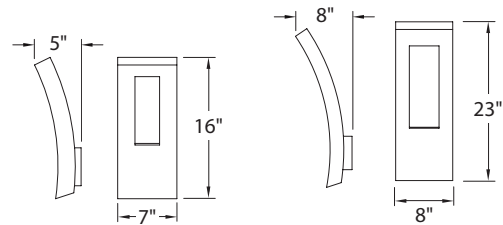

### PRODUCT DESCRIPTION

Cutting edge abstract design to complement modern architecture. Energy efficient indirect ambient lighting and down lighting creates bright, beautiful spatial illumination for superb security and architectural accent. Dawn provides a distinctive profile that reflects the best in urban refinement and sophistication.

### FEATURES

- ETL & cETL listed for wet locations, IP65
- Back light and down light
- Replaceable LED module
- 277V option available *special order*
- 50,000 hour potential life
- **Color Temp: 3000K**
- **CRI: 85**

### SPECIFICATIONS

- Construction:** Aluminum.
- Power:** No driver or transformer required.
- Light Source:** High output LED.
- Dimming:** Dims to 10% with an electronic low voltage (ELV) dimmer.
- Mounting:** Mounts directly to junction box.
- Finish:** Bronze (BZ), Graphite (GH).
- Standards:** ETL & cETL. Wet location. IP65

### ORDER NUMBER

Model#	Height	Finish
WS-W22	16"	<b>BZ</b> Bronze
	23"	<b>GH</b> Graphite

### FIXTURE PERFORMANCE

Part#	Watt	# of LEDs	LED Lumens	Photometric Lumens
<b>WS-W2216</b>	16W	4	960	490
<b>WS-W2223</b>	24W	6	1440	735

### REPLACEMENT GLASS

Part#	Fixture
<b>RPL-GLA-2216</b>	WS-W2216
<b>RPL-GLA-2223</b>	WS-W2223

**WS-W22**  -

Example: **WS-W2223-GH**  
 For 277V special order, add an "F" before the finish: **WS-W2223F-GH**

modernforms.com  
 Phone (800) 526.2588  
 Fax (800) 526.2585

Headquarters/Eastern Distribution Center  
 44 Harbor Park Drive  
 Port Washington, NY 11050

Central Distribution Center  
 1600 Distribution Ct  
 Lithia Springs, GA 30122

Western Distribution Center  
 1750 Archibald Avenue  
 Ontario, CA 91760