

Image Coming Soon

Project:

Location:

Fixture Type:

Catalog Number:

**AVAILABLE FINISHES:**

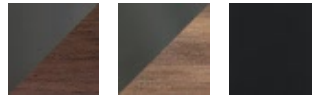

## Mykonos

FR-W1819

**PRODUCT DESCRIPTION**

You know a smart fan named after the Greek "Isle of Winds" is going to be timeless, and Mykonos delivers in spades. It's perfect for transitional spaces with its contrast finishes and streamlined look. Maximize control with the Modern Forms app, which can establish optimized schedules based on your behavior and reduce energy costs by connecting to your thermostat.

**FEATURES**

- Modern Forms Fans pair with the smart home tech you know and love, including Google Assistant, Amazon Alexa, Samsung Smart Things, Control 4, and Josh.ai.
- Integrates with smart home devices you already own, including Google Assistant and Amazon Echo for voice command and energy savings
- Bluetooth remote control included (Part# F-RCBT-WT). Optional wall switches are available for 3 or 4 way setup (Part# F-WCBT-WT).
- Additional battery operated Bluetooth hand-held remotes are available (Part# F-RCBT-WT)
- Silent DC motor runs 70% more energy efficient than traditional AC motors
- 5 years LED module, 2-years for finishes, lifetime on the motor, 1 year for all other parts.
- Every fan is factory-balanced and sound tested to ensure each fan will never wobble, rattle or click.

**SPECIFICATIONS**

Rated Life	50,000 Hours
Standards	UL, cUL, Wet Location Listed, Title 24 JA8: 2019 Compliant, Energy Star 2.0
Input	120 VAC, 50/60Hz
Color Temp	3500K, 2700K, 3000K
CRI	90
Construction	Aluminum Body With ABS Blades

**REPLACEMENT PARTS**

- RPL-F1819-52-BD-BZ - BLADE SET FOR F1819-52
- RPL-F1819-52-BD-MB - BLADE SET FOR F1819-52
- RPL-F1819-52-BD-OB - BLADE SET FOR F1819-52
- RPL-F1819-GLA - GLASS SHADE FOR F1819
- RPL-COU-CVR-1819BZ - HARDWARE PACKS FOR FAN
- RPL-COU-CVR-1819MB - HARDWARE PACKS FOR FAN
- RPL-COU-CVR-1819OB - HARDWARE PACKS FOR FAN
- RPL-CAN-RND-BZ - COUPLING COVER
- RPL-CAN-RND-MB - COUPLING COVER
- RPL-CAN-RND-OB - COUPLING COVER
- F3IN-120V-R1-30 - HANGER ASSEMBLY

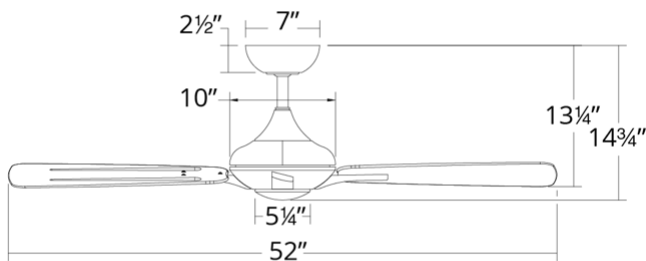

FR-W1819-52L

Model      Body &      High      LED Watts      LED Lumens      Delivered Lumens

CCT/CRI	Blade	CFM			
	<b>Finish</b>				
FR- W1 819 2700K - 90	MB MB - Matte Black	6001 6001 6001 6001	13W 13W 13W 13W	1110 1110 1110 1110	381 381 381 381
FR- W1 819 3500K - 90	MB MB - Matte Black	6001 6001 6001	13W 13W 13W	1110 1110 1110	381 381 381
	BZ DW	6001	13W	1110	381
	-	6001	13W	1110	381
FR- W1 819 3000K - 90	Bronze/Dark Walnut	6001	13W	1110	381
	MB MB - Matte Black				
	OB BW - Oil Rubbed Bronze/Barn Wood				
	BZ DW				
	-				
	Bronze/Dark Walnut				
	OB BW - Oil Rubbed Bronze/Barn Wood				
	BZ DW				
	-				
	Bronze/Dark Walnut				
	OB BW - Oil Rubbed Bronze/Barn Wood				

Example: **FR-W1819-52L350BBW**

For custom requests please contact [customs@modernforms.com](mailto:customs@modernforms.com)